



DP-8

Under Research & Development



The Art & Science of Sound.





Technical Specification

- **RMS Power:** 125W LF and 50W HF
- **Music Power:** 250W LF and 100W HF
- **Peak Power:** 500W LF and 200W LF
- **Frequency Response:** 60 Hz – 20kHz
- **Dimension (WDH):** 290 x 280 x 480 mm
- **Weight:** 9 kg



Eminence ASD-1001



Specification

Throat Size	1", 25.4mm
Nominal Impedance	8 ohms
Power Rating**	50W (EIA-426A specification w/ xover \geq 2.5kHz @ 18dB/octave)
Free Air Resonance	1.2kHz
Usable Frequency Range	2.5kHz-20kHz
Recommended Crossover	18dB/oct @ 2.5kHz
Sensitivity***	104.4dB (1W/1m across 2.5kHz-20kHz on axis on H290S horn)
Magnet Weight	12 oz., 0.34kg
Voice Coil Diameter	1.3", 33mm
Re	6.7 ohms
Minimum Impedance	7.7 ohms @ 3kHz

Mounting Information

Available in screw-on format only

Overall Diameter	3.5", 88.9mm
Mounting Thread	1 3/8" 18 UNEF ext.
Depth	2.45", 62.2mm
Weight	2 lbs, 0.9 kg
Volume	15.84 cu.in.

Materials of Construction

Voice Coil Former	Aluminum
Diaphragm Material	Titanium
Magnet Composition	Ferrite

ASD:1001 HF Drivers

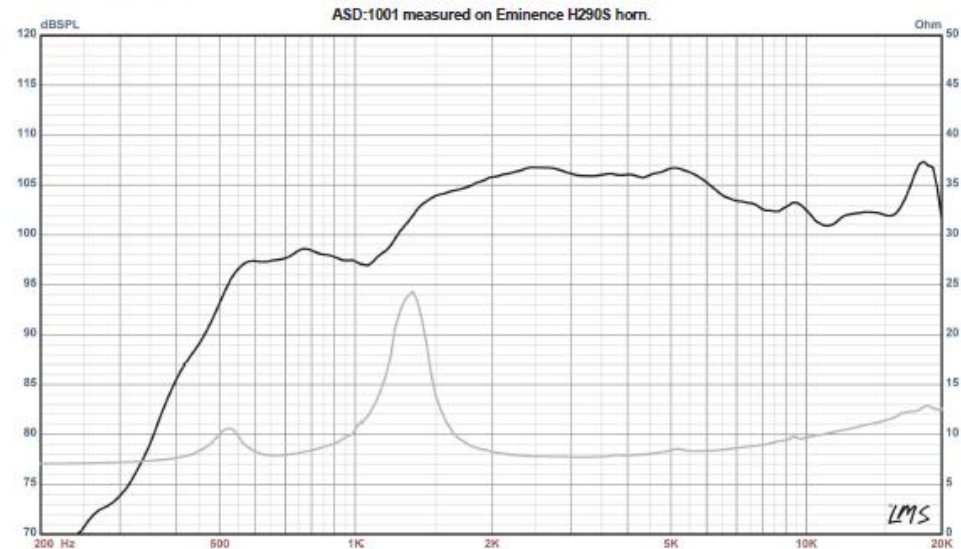

** Multiple units exceeded published power rating evaluated under EIA-426B specification while mounted on Eminence's H290 or H290S horn in a non-temperature controlled environment.

*** The average on axis output across the entire usable frequency range when mounted to the H290 or H290S horn and applying 1W/1m into the nominal impedance, i.e. 2.83V/8Ω, 4V/16Ω. Eminence response curves are measured under the following conditions: All speakers are tested at 1W/1m using a variety of test set-ups for the appropriate impedance | LMS using 0.25" supplied microphone (software calibrated) mounted 1m from wall/baffle | 2ft x 2ft baffle is built into the wall with horn front mounted | Carver PM-120 amplifier | 2700R3 chamber with fiberglass on all six surfaces (three with custom-made wedges).



Fane Sovereign 8-125

SOVEREIGN 8-125

Medium-power 8" driver ideal for use in pro-sound applications. Works well as a mid in small sealed boxes and as a mid/bass driver in vented boxes.



ELECTRO ACOUSTIC SPECIFICATIONS

Nominal Chassis Diameter	8"
Impedance	8 Ω
Power Handling	125 w (EIA 426A)
Peak Power (6dB Crest Factor)	500 w (EIA 426A)
Usable Frequency Range -6dB	60 Hz - 7 kHz
Sensitivity (1 w - 1 m)	94 dB
Moving Mass inc. Air Load	19
Minimum Impedance Zmin	7.6 Ω
Effective Piston Diameter	6.496" / 165 mm
Peak Displacement Volume of Cone Vd	0.073 litres
Magnet Weight	20 oz
Magnetic Gap Depth	0.23" / 6 mm
Flux Density	1.1 Tesla
Coil Winding Height	0.51" / 13 mm
Voice Coil Diameter	1.5" / 38.1 mm

MATERIALS OF CONSTRUCTION

Former Material	Glass Fibre
Voice Coil	Copper
Magnet Material	Ferrite
Chassis	Steel
Cone	Paper
Surround / Edge Termination	Polyvinyl Damped Dbl. Half Roll Linen
Dust Dome	Paper
Connectors	Solder Tag
Polarity	Positive Voltage at Red Terminal Causes Forward Motion of Cone

THIELE SMALL PARAMETERS

FS Hz	65 Hz
RE Ohms	6.7 Ω
Qms	6.6
Qes	0.75
Qts	0.68
Vas Ltr	19.5
Vd litres	0.074
CMS (mm/N)	0.3
BL T/m	8.5
Mms (grams)	19
Xmax (mm)	3.45
Sd (cm ²)	213
Efficiency %	0.7
Le (1kHz)	1.276 mH

MOUNTING / SHIPPING INFORMATION

Overall Diameter	8.18" / 208 mm
Flange Height	0.27" / 7 mm
Baffle Hole Diameter F/M	7.24" / 184 mm
Baffle Hole Diameter R/M	7.24" / 184 mm
Gasket Supplied	Front & Rear
Fixing Holes	8x 5.5 mm on 7.79" / 197.8 mm PCD
Depth	3.7" / 94 mm
Weight	3.85 lb / 1.75 kg
Recommended Enclosure Volume	0.35 - 0.88 cu ft / 10 - 25 litres
Shipping Weight	5.51 lb / 2.5 kg
Packing Carton Dimensions	130 x 240 x 240 mm

FREQUENCY RESPONSE DATA*

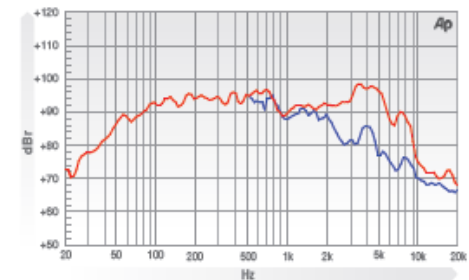

IMPEDANCE

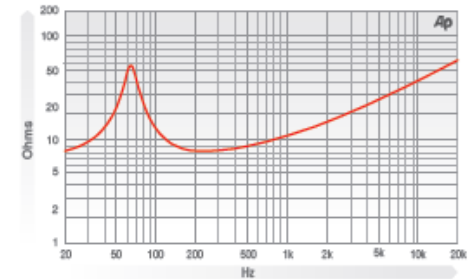

PREDICTED BASS RESPONSE

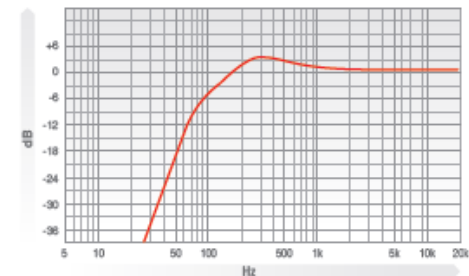



High Density Cabinet

- 5 kg weight cabinet
- WxDxH - 290 x 280 x 480 mm
- Solid sound reproduction





Strength

- Good clarity and bright sound
- Flat frequency response, less feedback
- Easily blend with 18" subwoofer's sound
- Extremely high density cabinet
- Eminence and Fane Inside



The Art & Science of Sound.





Target Market

- Stage monitor for singers, wind instrumentalist, Acoustic guitar, violin, electric guitarist
- Excellent for jazz, blues, vocal, R&B music reproduction
- Pub, bar, bistro and entertainment outlet
- Restaurants and cafe



Target System Design

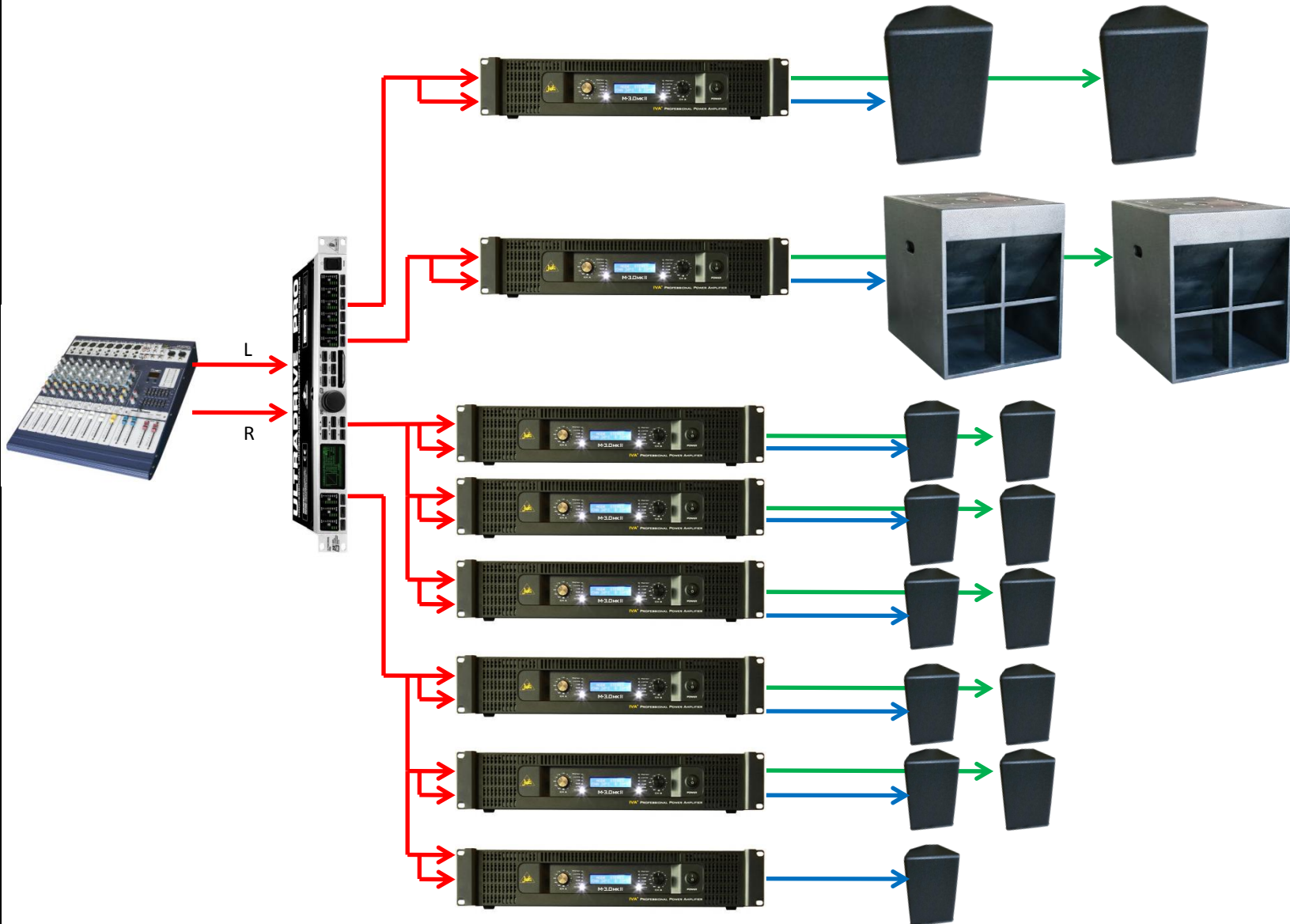



Example

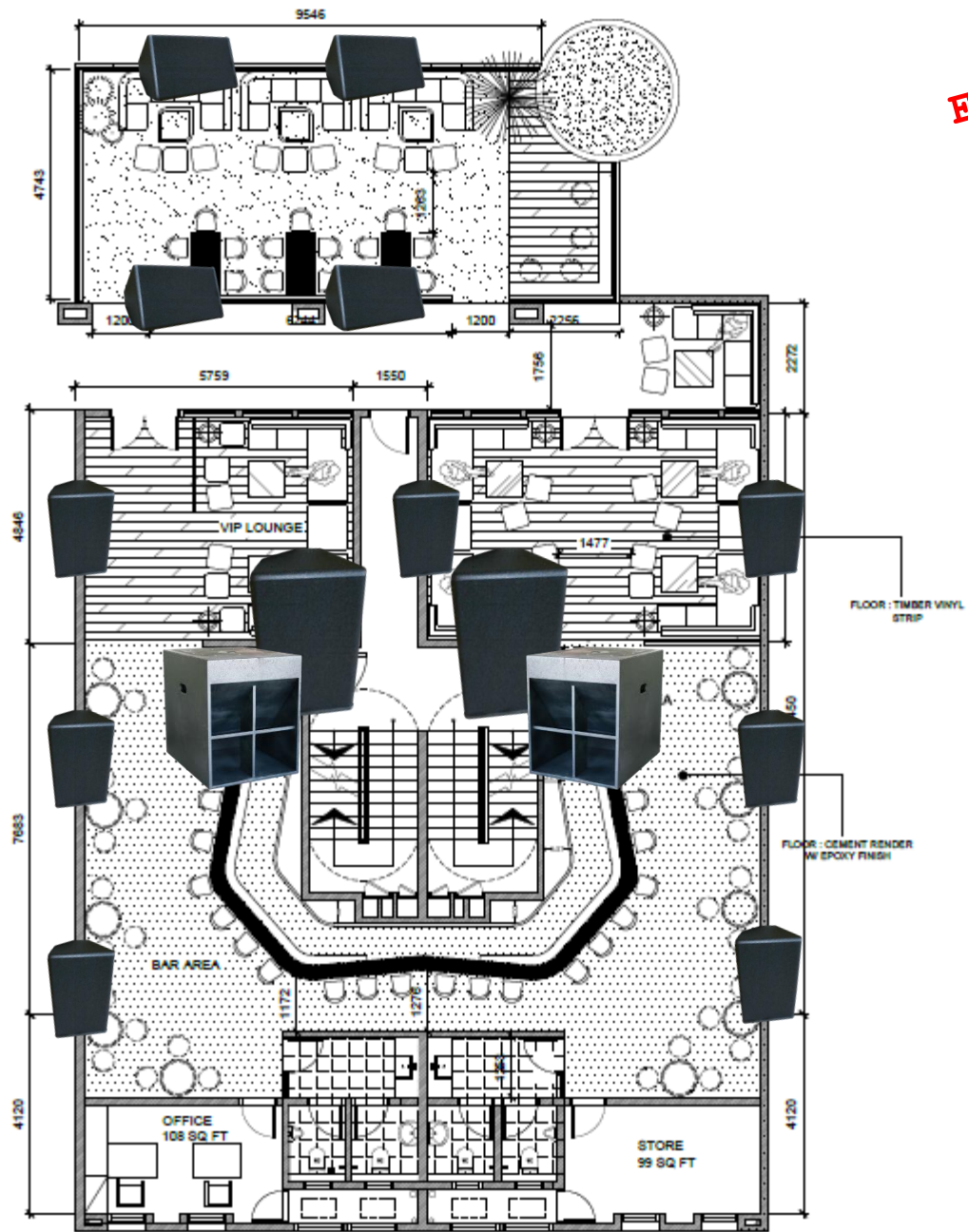

1ST FLOOR LAYOUT PLAN



Example

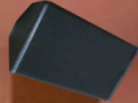
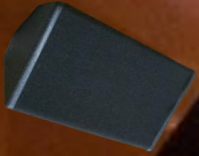



Prototype is available in AVEM

Showroom!!!

- Please spare some time to come down and listen yourself
- Please bring along you reference CD if you have.
- Your feedback is much appreciated
- Thank you

Contact person:

Eric Chee

019-3239580